



MELBOURNE ARTISTS TO ADORN PARTHENON TRIBUTE IN CONTEMPORARY ARTWORKS

NGV International | From 22 November 2022 | Free entry



9 November 2022: The NGV has announced the first three Melbourne artists to layer the 2022 NGV Architecture Commission *Temple of Boom* with dynamic and eye-catching painted artworks this summer.

Opening on 22 November, this year's commission in the NGV Garden is a contemporary tribute to global architecture icon, The Parthenon on the Acropolis.

Ranging from vibrantly coloured floral motifs to optical illusions, the artworks draw inspiration from the colourful and artistic embellishments that covered the original building over two-thousand years ago.

Designed by Melbourne-based architects Adam Newman and Kelvin Tsang, *Temple of Boom* invites audiences to consider the effect of time on all architecture as the structure gradually transforms with artworks and murals, painted in three phases between November 2022 and August 2023.

Guest curated by Toby Benador from Just Another Agency, the first round of participating artists includes **Drez**, **Manda Lane** and **David Lee Pereira**, whose artworks will be unveiled on 22 November when *Temple of Boom* opens to the public.

Drez is a multidisciplinary artist based in Melbourne who uses colour and form to play with perspective. Drawing inspiration from art historical perspectives, including the Greenbergian Modernism and Op-Art schools, Drez's work creates an intersection between abstract art and street art. For this installation, Drez will create a boldly colourful mural that changes composition when viewed from different angles.

Manda Lane is a muralist, illustrator and paper-based artist from Collingwood, Victoria. With a keen focus on botanicals, her art explores the interactions between the natural world and industrial or man-made objects. In this mural installation, Lane will depict various growth behaviours of plants, creating a visual metaphor for personal expression and growth.

David Lee Pereira is a visual artist whose works explore the fluidity of gender, sexuality and identity. Influenced by the work of impressionist and surrealist artists Georgia O'Keefe, Salvador Dali and Edvard Munch, Pereira will adorn the structure with large-than-life floral motifs that draw attention to nature's flamboyant use of scent and colour to allure pollinators.

Temple of Boom will be painted in three stages with the second and third group of artists adding further layers of artwork in 2023.

Tony Ellwood AM, Director of the NGV, said: 'By inviting local artists to cover this modern interpretation of The Parthenon in contemporary art, *Temple of Boom* overlays this ancient structure with new connections to time and place – especially here in Melbourne. This thought-provoking work by Adam Newman and Kelvin Tsang invites us to consider the legacy of architectural symbols like The Parthenon, as well as how this meaning can shift across time periods and cultures.'

Taking its name from the vibrations of music, *Temple of Boom* is envisioned as a community meeting place and an outdoor venue for a diverse program of NGV-curated performances, programs and music across the summer period. Visitors are invited to celebrate the opening week on Saturday 26 November with an afternoon of free talks and performances presented in partnership with the Hellenic Museum. From 16 December to 14 April, some of Melbourne's best DJs will perform every week as part of the return of NGV Friday Nights this summer. The historical and cultural significance of the Parthenon and its continuing resonance for the Greek diaspora will also be celebrated with diverse programming across the nine-month installation.

The NGV Architecture Commission 2022: *Temple of Boom* will be on display from 22 November 2022 at NGV International, St Kilda Road, Melbourne. Free entry. Further information is available via the NGV website: [NGV.MELBOURNE](https://www.ngv.com.au)

The 2022 NGV Architecture Commission is supported by Principal Partner Macquarie Group, Design Partner RMIT University, The Hugh D. T. Williamson Foundation and CERES Fair Wood.

The NGV Architecture Commission Design Competition process is developed and delivered by CityLab.

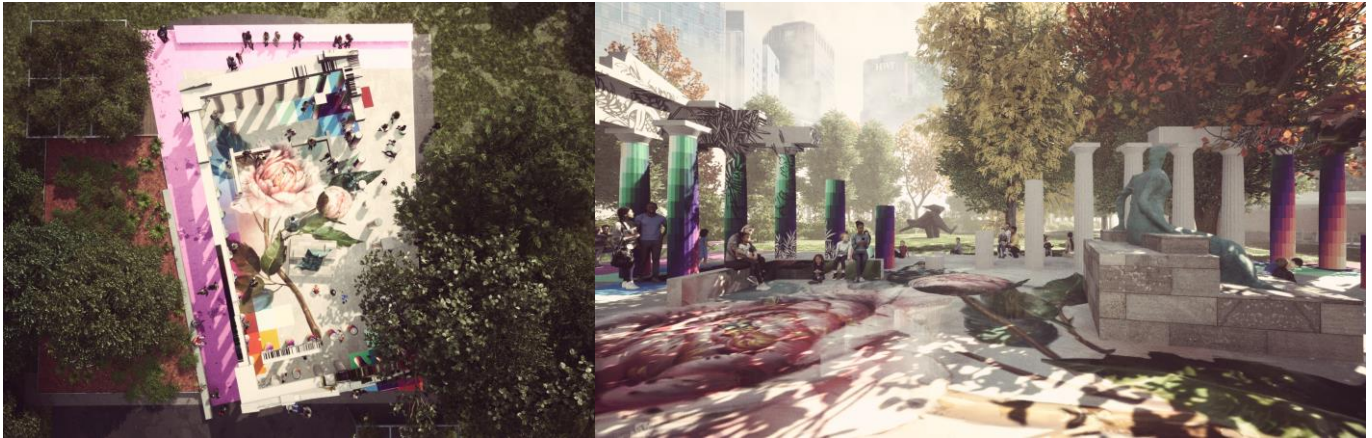

ABOUT THE NGV ARCHITECTURE COMMISSION SERIES

Since its inception in 2016, the annual NGV Architecture Commission has enlivened the NGV's Grollo Equiset Garden, creating a place for community, programs and events, as well as respite from the summer sun. Ranging from a pink pool inspired by Australia's inland salt lakes to a thought-provoking meditation on the architectural legacy of Traditional Owners, the 2022 Architecture Commission marks the series' seventh iteration.

The NGV Architecture Commission has previously been designed by [Taylor Knights + James Carey](#) (2021), Yhonnie Scarce and [Edition Office](#) (2019), [MUIR + OPENWORK](#) (2018), Retallack Thompson and [Other Architects](#) (2017), [M@ STUDIO Architects](#) (2016), [John Wardle Architects](#) (2015).

In 2017 M@ Studio's hyperreal suburban carwash *Haven't you always wanted...?* won the Melbourne Prize in the Victorian Architecture Awards. In 2018 Retallack Thompson and Other Architects' *Garden Wall*, a maze-like series of open-air passageways, corridors and rooms was awarded a commendation in the Victorian Architecture Awards Small Projects category. In 2019 Muir + Openwork's *Doubleground* was awarded the Australian Institute of Architects national award for small project architecture and the Victorian chapter's Kevin Borland award for small project architecture. In 2020 Yhonnie Scarce and Edition Office's *In Absence* won the Victorian chapter's Kevin Borland award for small project architecture and the global award for small building of the year at the 2020 Dezeen Awards. In 2022 *Pond[er]* by Taylor Knights + James Carey received an architecture award in Victorian Architecture Awards Small Projects category.

ABOUT THE ARCHITECTS

Adam Newman is an architect at NWMN, a small architecture practice based in Melbourne. At NWMN, Adam's principal focus is on adaptive building re-use and regeneration through the lens of conscious engagement with local ecologies. He has broad experience at the scales of urban master planning, social housing regeneration, civic and residential architecture, and industrial design and fabrication. Adam is a registered architect (ARBV), a member of Architeam, and a teaching associate at Monash University, Department of Architecture.

Kelvin Tsang is lead designer and technical director at NWMN. His interests lie in using narrative-driven architectural design and image production to promote conversations about architecture's role as a driver of positive change. Along with practice-based work on residential, commercial and interior projects, Kelvin is a teaching associate at Monash University, Department of Architecture. With a Master's degree in Architecture from Monash University, Kelvin received Top Student in Master's Studio and Top Project in Masters Studio in consecutive years.

-ends-

Media Contacts:

Kate Atkinson kate@articulatepr.com.au / 0466 182 681
Kym Elphinstone kym@articulatepr.com.au / 0421 106 139

PREVIOUS NGV ARCHITECTURE COMMISSION WINNERS

[2015 NGV Architecture Commission](#)

[2016 NGV Architecture Commission](#)

[2017 NGV Architecture Commission](#)

[2018 NGV Architecture Commission](#)

[2019 NGV Architecture Commission](#)

[2021 NGV Architecture Commission](#)

Image credit: Renders of 2022 NGV Architecture Commission *Temple of Boom* by Adam Newman and Kelvin Tsang. Renders courtesy of Adam Newman and Kelvin Tsang.

IMAGES: <https://www.dropbox.com/sh/c06ix28jyp1vxss/AAAQXFjO4Dt0oOzipRqQAoDda?dl=0>

The 2022 Architecture Commission is generously supported by:

PRINCIPAL PARTNER

DESIGN PARTNER



MACQUARIE



The 2022 NGV Architecture Commission is supported by The Hugh D. T. Williamson Foundation.

The NGV gratefully acknowledges CERES Fair Wood for their generous support of the 2022 Architecture Commission.

The NGV Architecture Commission Design Competition process is developed and delivered by CityLab.